



Manual Transaxle System

Manual Transaxle Gear System - Differential

Components

Apply ATF fluid on any moving part on installation.

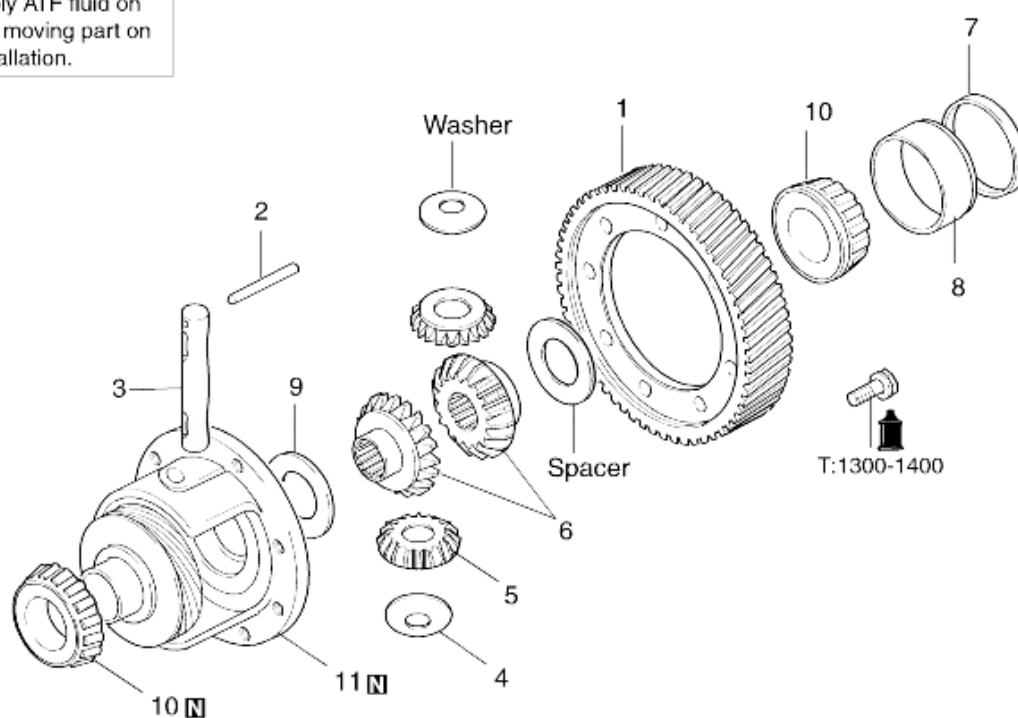

Torque: N-m (kg-cm, lb-ft)

Ⓜ Marked part shall be replaced with new part.

1. Differential drive gear
2. Lock pin
3. Pinion shaft
4. Washer
5. Pinion gear
6. Side gear

7. Spacer
8. Outer race
9. Spacer
10. Taper roller bearing
11. Differential case

Disassembly

1. Remove the taper roller bearing.

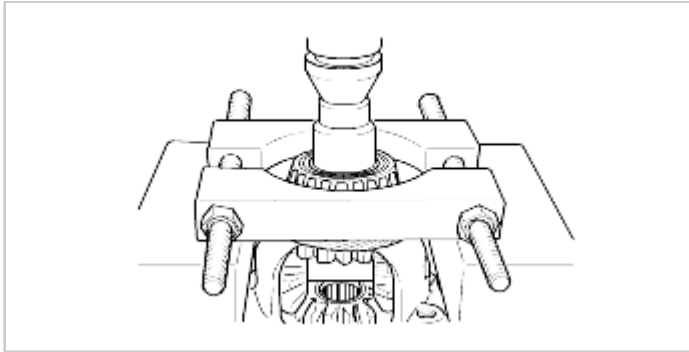

Reassembly

1. Remove the spacer, the side gear, the washer, the pinion and the pinion shaft.
 - (1) Connect the side gear with the spacer, and install the side gear into differential case.

NOTE

Use a spacer of neutral thickness
0.037~0.039in(0.93~1.00mm) for a new side gear.

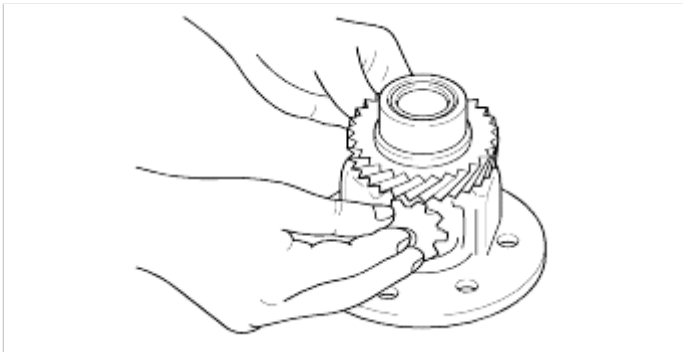

- (2) Connect the washer to the pinion and install them simultaneously at the point so that they may lock with the side gear.
- (3) Install the pinion shaft.

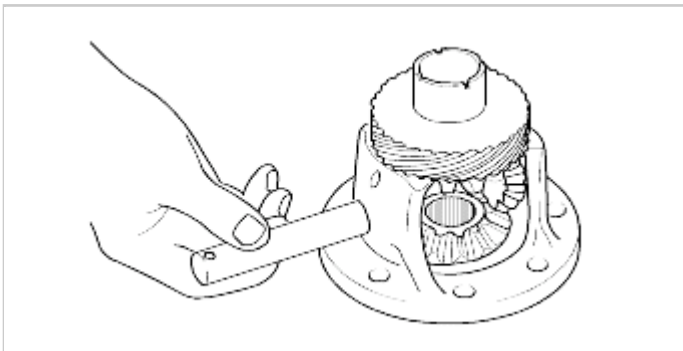

- (4) Check the side gear pinion backlash and install a proper spacer.

Standard value :
0.00098~0.0059in(0.025~0.150mm)

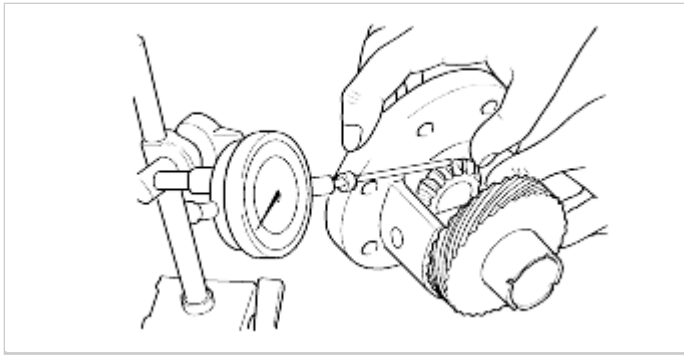

NOTE

Adjust backlashes at both sides to be within standard value.

2. Install the lock pin.
Install the lock pin at the direction illustrated on the figure.

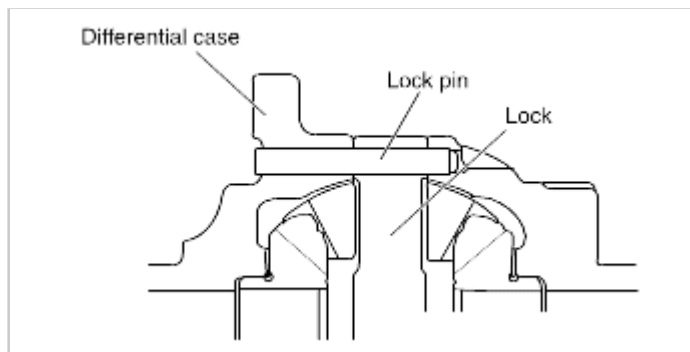

3. Install the taper roller bearing.

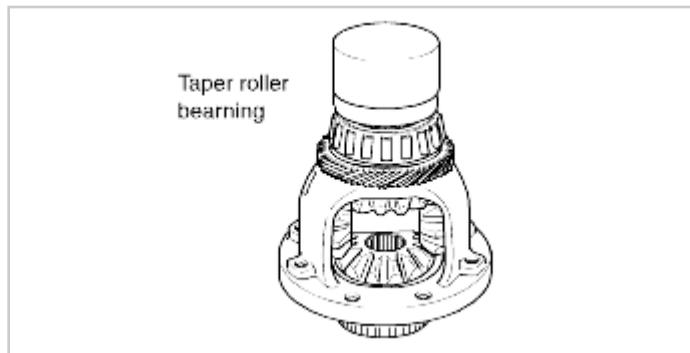

4. Install the differential drive gear.
5. Apply ATF on bolts and install them in the order illustrated on the figure and tighten them with tightening torque.

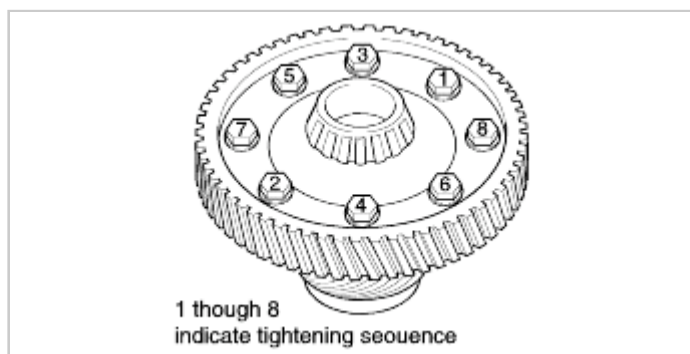



Manual Transaxle System

Manual Transaxle Gear System - Speedometer
Driven Gear Assembly

Components

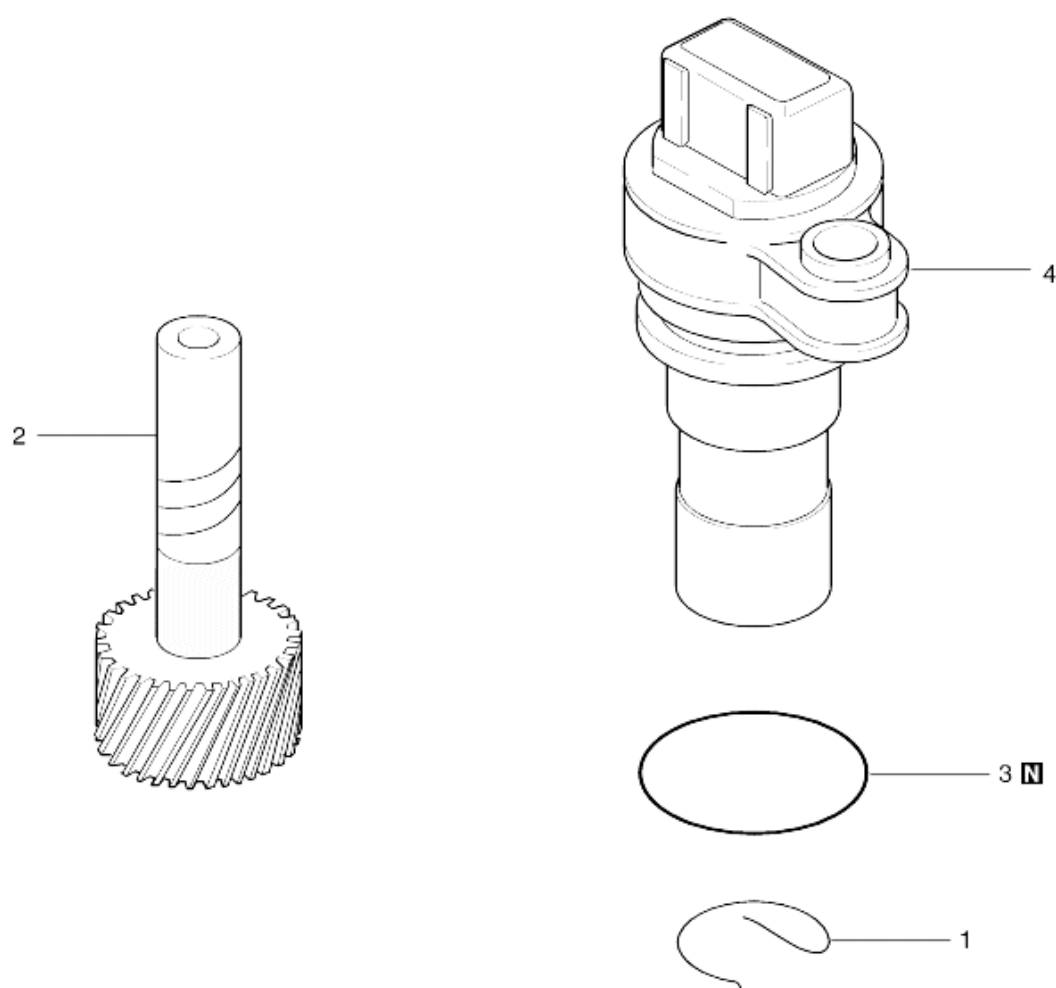

Apply ATF fluid on any moving part on installation.

N Marked part shall be replaced with new part.

Disassembly procedure

1. E-clip
2. Speedometer driven gear

3. O-ring
4. Sleeve